

ISSUE DATE: 2013-02-01  
 REV. DATE: 2015-09-08  
 CODE: NORM000035 - 04

## CLEANING

## INTENSIVE GRAIN DAMPENER MOD.BI

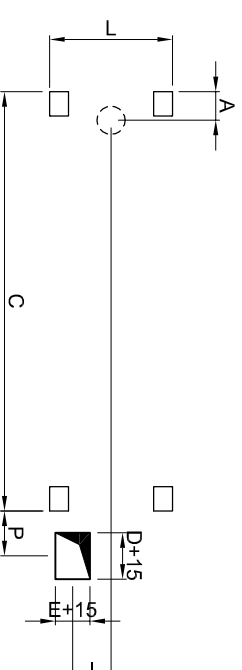
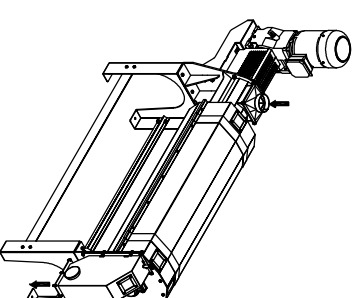
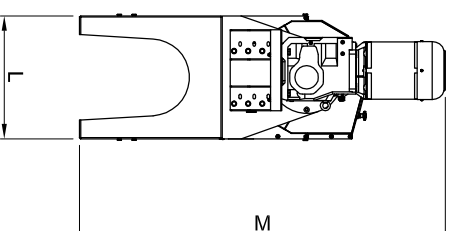
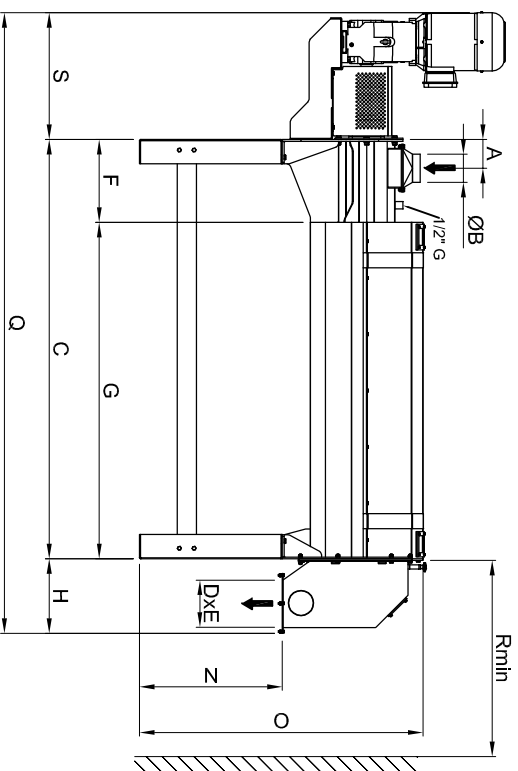

TYPE	DIMENSIONS [mm]																HOURLY PRODUCTION [t/h]	ROTOR DIAMETER [mm]	SPEED [rpm]	POWER REQUIREMENT [kw]	WEIGHT [kg]	SEA PACKING VOLUME [m³]
	A	B	C	D	E	F	G	H	I	L	M	N	O	P	Q	R						
BI40-7.5	132	120	2136	200	130	342	1800	340	148	506	1830	760	1396	208	3042	2420	7	400	130	7.5	450	3
BI40-9.2	132	120	2136	200	130	342	1800	340	148	506	1830	760	1396	208	3042	2420	7-10	400	135	9.2	450	3
BI60-11	153	150	2234	250	185	442	1800	400	205	655	1947	760	1510	238	3310	2600	10-13	600	129	11	820	4.8
BI60-15	153	200	2234	250	185	442	1800	400	205	655	1947	760	1510	238	3310	2600	13-18	600	130	15	850	4.8
BI60-22	153	200	2234	250	185	442	1800	400	205	655	1620	760	1510	238	3790	2600	18-25	600	138	22	890	5.4